



HKC-KC Series Hall Effect Current Sensor

HKC-KC Series current sensor with a galvanic isolation between primary and secondary circuit. It provides accurate electronic measurement of DC, AC or pulsed currents.

ELECTRICAL DATA							
	Part No.	HKC1000K	HKC3000K	HKC5000	HKC8000K	HKC10000	
I_{PN}	Rated input current	1000	3000	5000	8000	10000	A
I_P	Test current range	0~±2000	0~±6000	0~	0~±12000	0~±12000	A
V_{OUT}	Rated output voltage	4±1%					V
V_C	Supply voltage	±15(±5%)					V
I_C	Current loss $V_C=±15V$	<35					mA
V_d	Insulation voltage	6 @/50Hz/1min,Pri to Sec					kV
ϵ_L	Linearity	<0.5					%FS
V_0	Zero offset voltage $T_A=25^\circ C$	<±25					mV
V_{OM}	Magnetic offset voltage $I_{PN}\rightarrow 0$	<±30					mV
V_{OT}	Offset voltage temp. Drift $I_P=0, T_A=-25\sim+85^\circ C$	<±1					mV/°C
T_r	Response time	<7					µs
f	Bandwidth(-3dB)	DC~3					kHz
T_A	Operating Temperature	-25~+85					°C
T_S	Storage Temperature	-40~+100					°C
R_L	Load DCR	≥10K					Ω
m	Weight	1220					g

MUTING DIMENSIONS(FOR REFERENCE ONLY (mm))

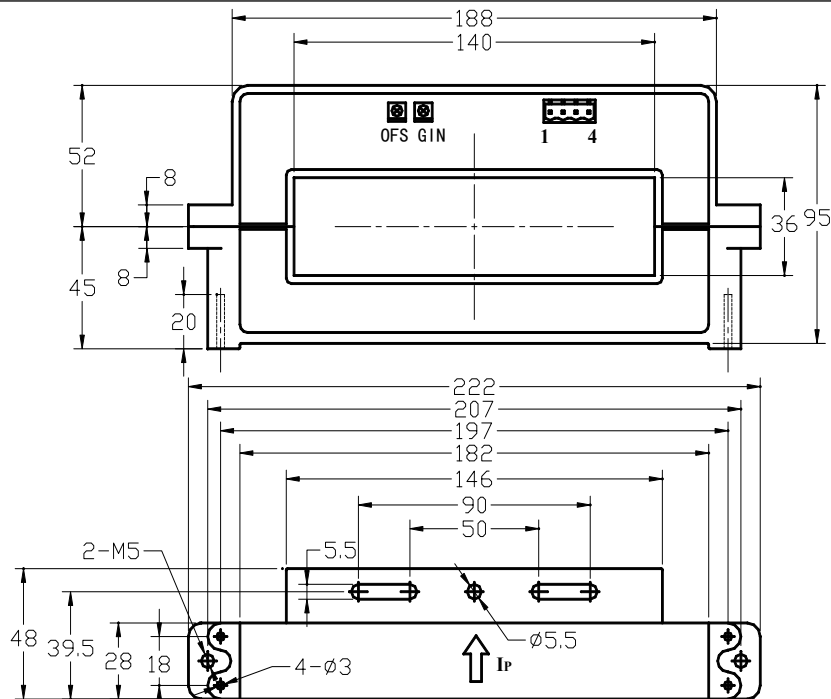

Terminal: 1,+15V 2,-15V 3,VOUT 4,0V(ground) OFS,Zero adjustment GIN,Amplitude adjustment
 Lead: Red,+15V Blue,-15V Yellow,VOUT Black,0V(ground)

INSTRUCTIONS FOR USE

1. When the current will be measured goes through a sensor, the voltage will be measured at the output end. (Note: The false wiring may result in the damage of the sensor).
2. The output amplitude of the sensor can be adjusted according to users requirements.
3. Custom design in the nominal input current and the output voltage available