

SMD Inductors(Coils) For Power Line(Wound, Magnetic Shielded) LPS6012 SERIES



FEATURES:

- Magnetically shielded by magnetic powder molding
- Miniature size: Mount area: 6x6mm, Height: 1.2mm max.
- Generic use for portable DC to DC converter line.
- High magnetic shield construction should actualize high resolution for EMC protection.
- Available for automatic mounting in tape and reel package.
- The products do not contain lead and support lead-free soldering.

APPLICATIONS:

- Cellular phones, DVCs, DSCs, PDAs, LCD displays, HDDs, etc

SHAPE AND DIMENSIONS Dimensions(mm)

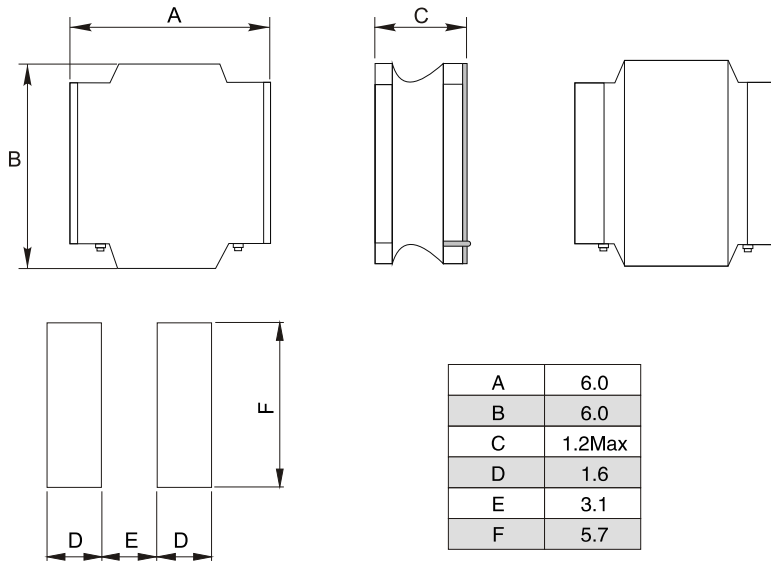

ELECTRICAL CHARACTERISTICS:

Part No.	Inductance (uH)	Inductance tolerance %	Test frequency KHz	SRF MHz	DCR (Ω) ±20%	Rated current*	
						Saturation current	Based on temperature rise
LPS6012-2R5N	2.5	± 30	100	45	0.09	2.1	1.73
LPS6012-4R0N	4.0	± 30	100	39	0.105	1.8	1.57
LPS6012-5R3M	5.3	± 20	100	34	0.125	1.5	1.4
LPS6012-6R8M	6.8	± 20	100	30	0.165	1.3	1.18
LPS6012-100M	10	± 20	100	22	0.235	1.0	1.0
LPS6012-150M	15	± 20	100	18	0.33	0.8	0.79
LPS6012-220M	22	± 20	100	12	0.53	0.76	0.63
LPS6012-330M	33	± 20	100	8	0.7	0.59	0.53
LPS6012-470M	47	± 20	100	6	1.05	0.52	0.46
LPS6012-680M	68	± 20	100	3	1.35	0.44	0.41
LPS6012-101M	100	± 20	100	1	2.18	0.35	0.32

Notes:

1. All test data is referenced to 20°C ambient.
2. Rated current: Isat or Irms, whichever is smaller.
3. Isat: DC current at which the inductance drops approximate 30% form its value without current.
4. Irms: DC current that causes the temperature rise (ΔT=40°C) form 20°C ambient.