

SHIELDED SURFACE-MOUNT POWER INDUCTORS

SPI1306S SERIES



FEATURES:

- Current up to 3.9A
- Very Small Foot Print
- Flat-top for Pick & Place

COMMON APPLICATIONS:

- Ideal for Palm-Top and Laptop DC-DC Converters
- PDA's Flash Memory
- Step-up, Step-down Converters

ELECTRICAL CHARACTERISTICS :

Part Number SPI1306S-	L (μ H) $\pm 20\%$	DCR (Ω) Max	IDC (A) Max
100	10	0.040	3.9
150	15	0.048	3.4
220	22	0.059	3.1
330	33	0.075	2.8
470	47	0.097	2.4
680	68	0.138	2.0
101	100	0.207	1.7
151	150	0.293	1.3
221	220	0.470	1.1
331	330	0.780	0.86
471	470	1.08	0.73
681	680	1.40	0.64
102	100	2.01	0.53

- Testing: (Equivalent acceptable)
Inductance: HP4285A
RDC: QuadTech 1880 Milliohmeter
-Q- HP4342A - SRF-HP4191A
- IDC Max: Determined when superimposed DC current is decreased 10% against its initial value
- Operating Temperature: -40°C to +85°C
- Storage Temperature: -40°C to +105°C
- Solder methods: Vapor Phase, Infrared Reflow
- Resistance to soldering heat: 260°C for 10 seconds
- Solvent resistance: Conforms to MIL-STD-202E
- Marking: Inductance & Tolerance

PHYSICAL CHARACTERISTICS

DIMENSION:(mm)

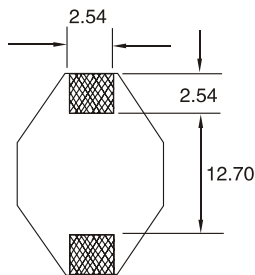
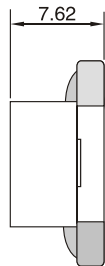
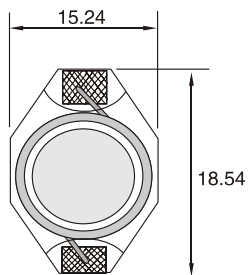

PAD LAYOUT

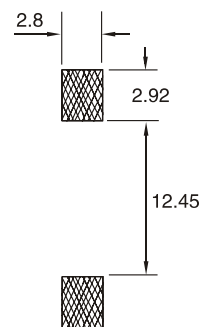

Note: All specification subject to change without noticed.